

SITE LOCATION MAP

1" = 2000'±

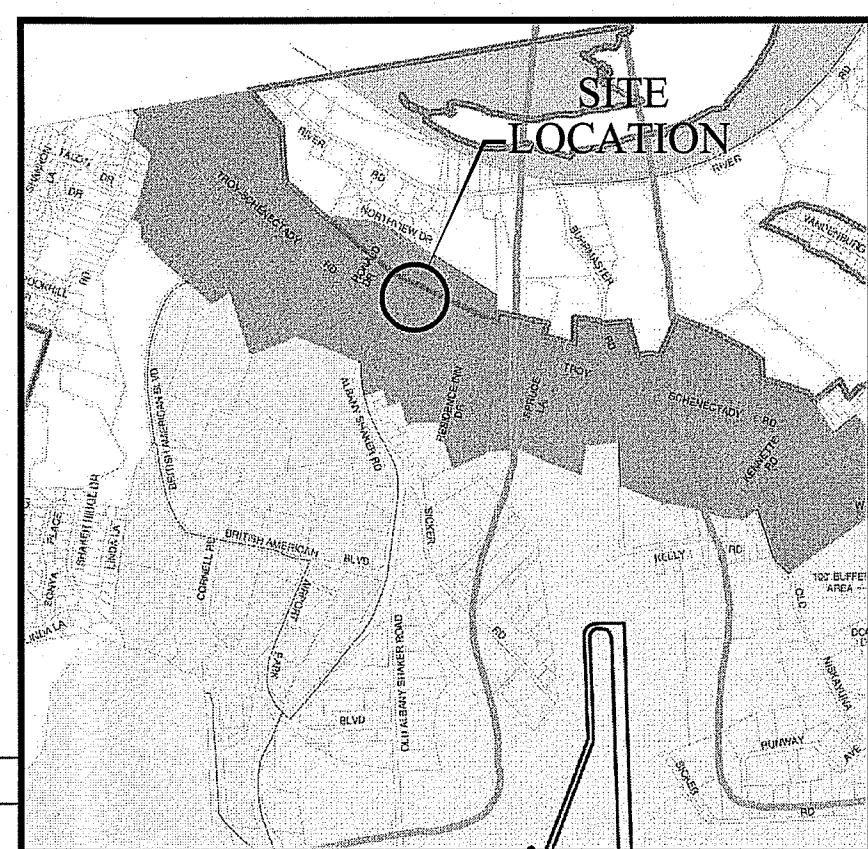

ZONING MAP

N.T.S.

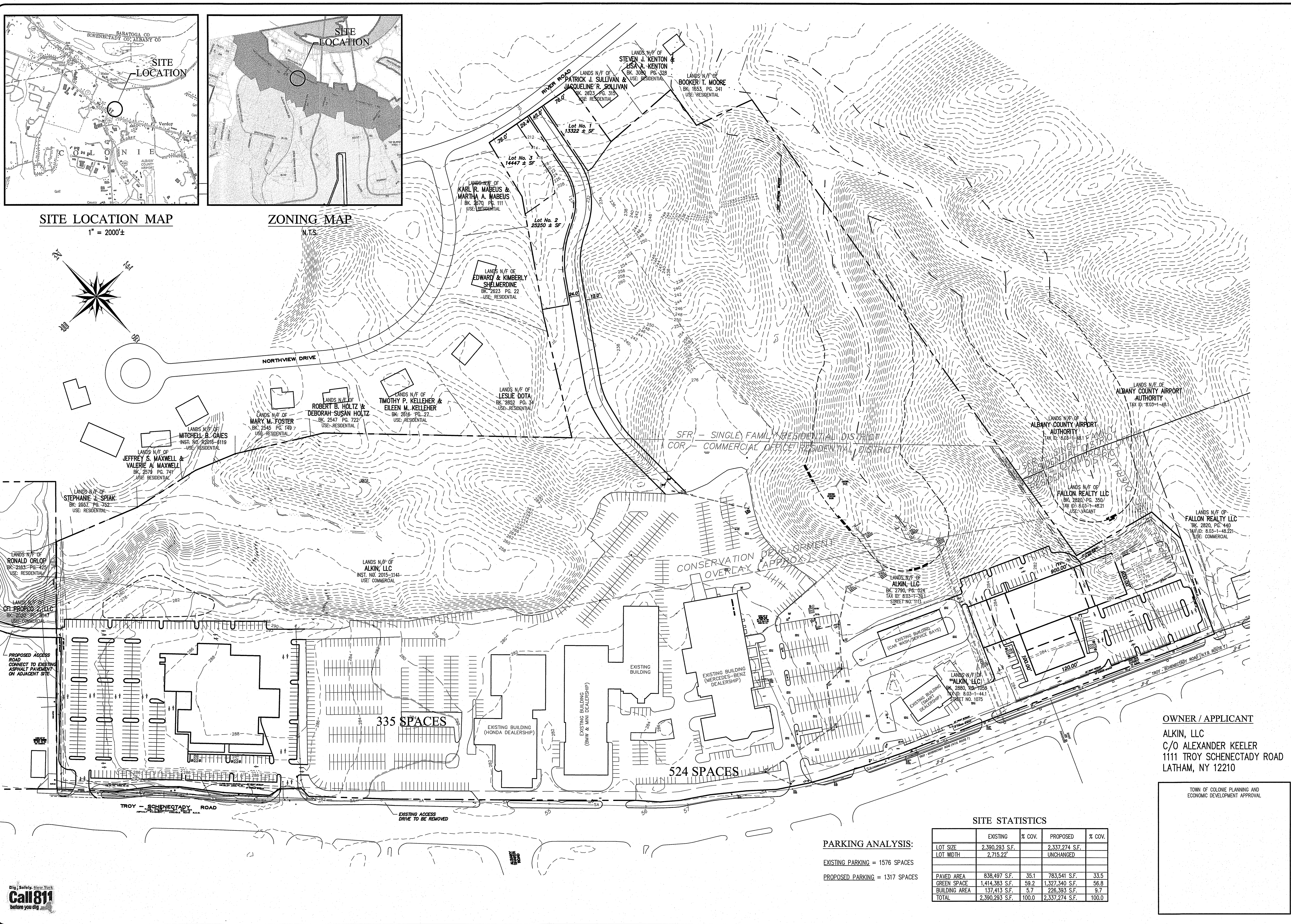
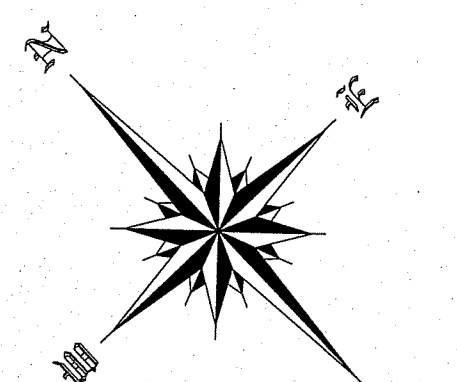

335 SPACES

524 SPACES

SITE STATISTICS

	EXISTING	% COV.	PROPOSED	% COV.
LOT SIZE	2,390,293 S.F.		2,337,274 S.F.	
LOT WIDTH	2,715.22'		UNCHANGED	
PAVED AREA	838,497 S.F.	35.1	783,541 S.F.	33.5
GREEN SPACE	1,414,383 S.F.	59.2	1,327,340 S.F.	56.8
BUILDING AREA	137,413 S.F.	5.7	226,393 S.F.	9.7
TOTAL	2,390,293 S.F.	100.0	2,337,274 S.F.	100.0

PARKING ANALYSIS:

EXISTING PARKING = 1576 SPACES
 PROPOSED PARKING = 1317 SPACES

OWNER / APPLICANT
 ALKIN, LLC
 C/O ALEXANDER KEELER
 1111 TROY SCHENECTADY ROAD
 LATHAM, NY 12210

TOWN OF COLONIE PLANNING AND ECONOMIC DEVELOPMENT APPROVAL

NO.	REVISION	BY	APPR.	DATE
1)	ISSUED FOR REVIEW	TAK	NC	11-4-2020

ALTERNATIVE FOR ALTERNATIVE FOR...
 COPYRIGHT 2020...
 ONLY COPIES FROM THE...
 UNLESS HE IS OBTAINING...
 THE EXECUTOR OF THE...
 UNLESS HE IS OBTAINING...
 THE EXECUTOR OF THE...
 UNLESS HE IS OBTAINING...
 THE EXECUTOR OF THE...



Design of:
ADVANCE ENGINEERING & SURVEYING, PLLC
 CONSULTING IN -
 CIVIL & ENVIRONMENTAL ENGINEERING
 LAND SURVEYING & DEVELOPMENT
 COMMERCIAL AND RESIDENTIAL

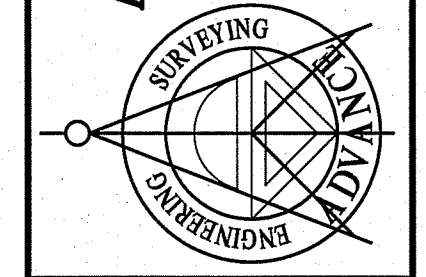

OVERALL CONCEPT SITE PLAN
KEELER MOTOR CAR COMPANY
1111 TROY SCHENECTADY ROAD
 1111 TROY SCHENECTADY ROAD, TOWN OF COLONIE
 COUNTY OF ALBANY STATE OF NEW YORK
 DATE: AUGUST 17, 2020 SCALE: 1" = 100'

SHEET NO.
OVRL-SITE
 2 OF 7 15009-COLL-SITE

V:\1513\Bentley\15009-COLL-SITE\15009-COLL-SITE.dwg, 11/5/2020, 10:56:30 AM, CADIS-4, 11

