

File Name: F:\mjb43\mjb43\_10 Colonie - 1209 Troy Schenectady Road Office Building\MJB43\_10 C-120 Layout.dwg (Layout: C-120)  
 Date: Thu, Nov 15, 2018 - 1:25 PM (Name: jblanchi)

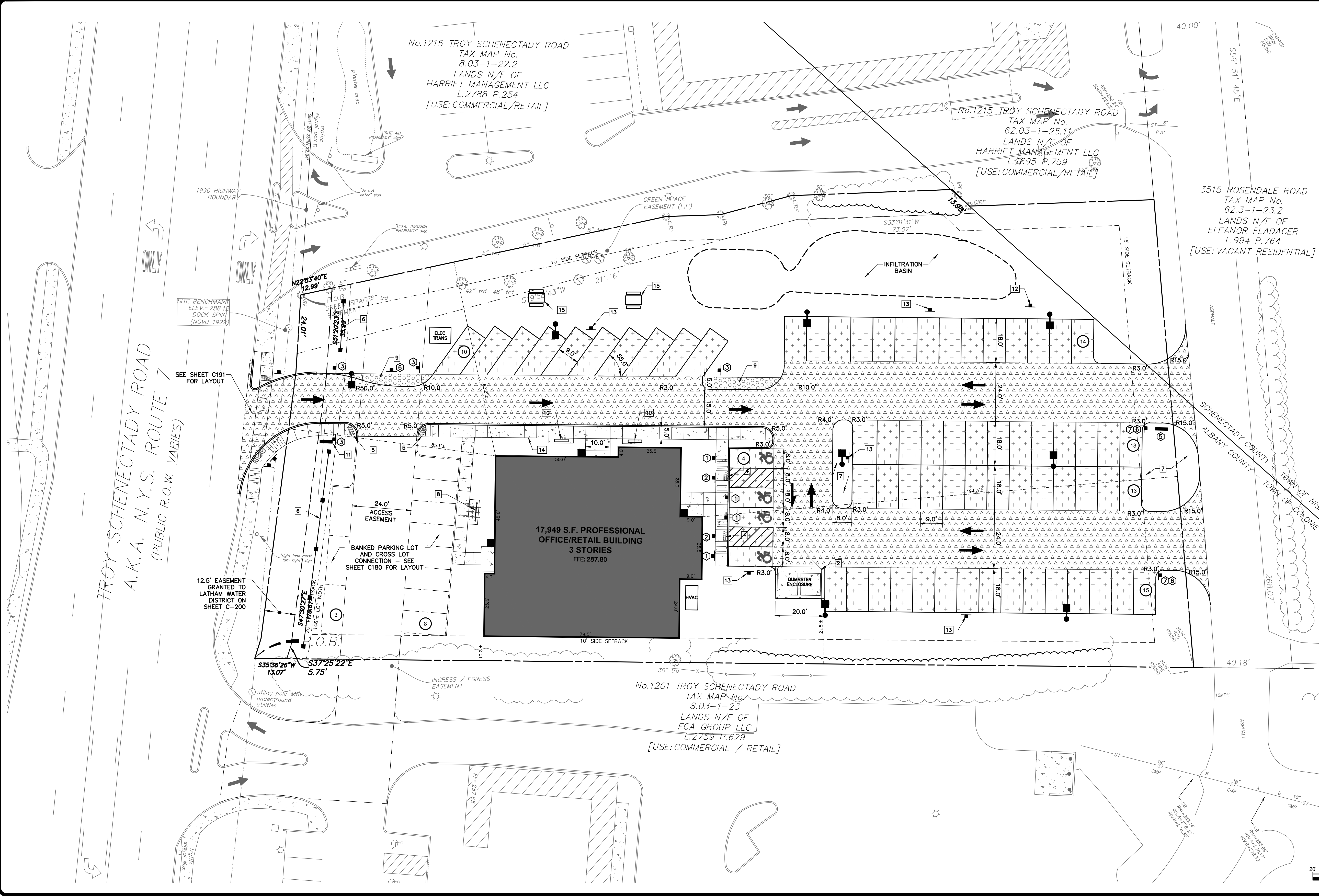

- KEY NOTES**
1. CAST-IN-PLACE CONCRETE CURB, SEE DETAIL 1/C501.
  2. DUMPSTER ENCLOSURE, SEE DETAIL 1/C502.
  3. PAINTED CROSSWALK, SEE DETAIL 7/C500.
  4. CURB RAMP, SEE DETAIL 4/C501.
  5. CURB RAMP, SEE DETAIL 5/C501.
  6. ORNAMENTAL FENCE, SEE DETAIL 4/C502.
  7. PARKING LOT BULE OUT OR ISLAND W/ LANDSCAPING OR LAWN. SEE LANDSCAPING PLAN.
  8. BIKE RACK, SEE DETAIL 7/C501.
  9. REINFORCED TURF, SEE DETAIL 4/C500.
  10. BENCHES, TYPE AND SIZE TO BE DETERMINED BY OWNER.
  11. NEW FREE STANDING SIGN. SIGN SHOWN FOR ILLUSTRATION PURPOSES ONLY. PERMITTING FOR THE SIGN SHALL BE A SEPARATE APPLICATION MADE TO THE TOWN.
  12. STORMWATER MANAGEMENT SIGN-SW SIGN#1, SEE DETAIL 6/C504.
  13. STORMWATER MANAGEMENT SIGN-SW SIGN#2, SEE DETAIL 6/C504.
  14. CAST-IN PLACE CONCRETE SIDEWALK, SEE DETAIL 5/C500.
  15. WOOD PICNIC TABLES

**SIGN SCHEDULE**

SIGN NO.	SIGN FACE	MUTCD NUMBER	MIN SIZE	BCK GRND	COLORS LEGEND	MOUNTING
1		R7-8 MOD	12"x18"	WHITE/BLUE	GREEN/WHITE	DETAIL 6/C500
2		R7-1	12"x18"	WHITE	RED	DETAIL 6/C500
3		R5-1	30"x30"	RED	WHITE	DETAIL 6/C500
4		R6-2R	18"x24"	WHITE	BLACK	DETAIL 6/C500
5		CUSTOM	24"x18"	WHITE	BLACK	DETAIL 6/C500
6		R3-2	30"x30"	RED	WHITE	DETAIL 6/C500
7		CUSTOM	24"x18"	WHITE	BLACK	DETAIL 6/C500

- LEGEND**
- PROPOSED BUILDING
  - PROPOSED CURB SEE DETAIL 1/C501
  - PROPOSED SIGN SEE DETAIL 3/C501
  - CONCRETE SURFACE SEE DETAIL 5/C500
  - STANDARD ASPHALT SEE DETAIL 1/C500
  - POROUS ASPHALT SEE DETAIL 2/C500
  - REINFORCED TURF SEE DETAIL 4/C500

TOWN OF COLONIE  
 PLANNING BOARD APPROVAL

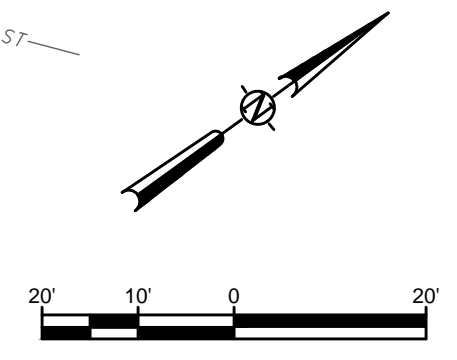

THE ALTERATION OF THIS MATERIAL IN ANY WAY, UNLESS DONE UNDER THE DIRECTION OF A COMPARABLE PROFESSIONAL, (I.E.) ARCHITECT FOR AN ARCHITECT, ENGINEER FOR AN ENGINEER OR LANDSCAPE ARCHITECT FOR A LANDSCAPE ARCHITECT, IS A VIOLATION OF THE NEW YORK STATE EDUCATION LAW AND/OR REGULATIONS AND IS A CLASS "A" MISDEMEANOR.

SUBMITTAL / REVISIONS					
No.	DATE	DESCRIPTION	BY	REVIEWED BY:	DATE
1	3/1/18	PRELIMINARY SUBMISSION TO TOWN	BS/SP	JB	2/28/18
2	7/06/18	RESPONSE TO TOWN REVIEW COMMENTS	BS/SP	JB	7/06/18
3	11/19/18	RESPONSE TO NYSDOT COMMENTS	BS/SP	JB	11/19/18

PROJ. MANAGER: JMB  
 CHIEF DESIGNER: SDP  
 DESIGNED BY: RES  
 DRAWN BY: RES  
 CHECKED BY: JMB

**Engineering and Land Surveying, P.C.**  
 1533 Crescent Road - Clifton Park, NY 12065

LECCE REAL ESTATE, LLC  
**LAYOUT PLAN**  
 1209 TROY SCHENECTADY ROAD  
 PROPOSED OFFICE / RETAIL BUILDING  
 TOWN OF COLONIE, ALBANY COUNTY, NEW YORK  
 TOWN OF NISKAYUNA, SCHENECTADY COUNTY, NEW YORK

SCALE: 1" = 20'  
 CONTRACT No.: -  
 MJ PROJ. No.: 843.10  
 DATE: 07/06/2018  
**C-120**  
 5 OF 20